

---

## Service Bulletin

---

S.B. No: 172

**Title:** INSPECTION OF FLAP DRIVE TORQUE TUBE

**Classification:** This Service Bulletin has been classified by SAL as Highly Recommended

**Compliance:** At next Annual Inspection, and subsequent Annual Inspections, until Mod. M948 has been embodied.

**Applicability:** T67A, T67B, T67C, T67M, T67M-MkII, T67M200, T67M260 (Pre Mod M950) and T67M260-T3A

### INTRODUCTION:

Cases have been reported of cracks at the inboard and outboard ends of the flap drive torque tube.

### ACTION:

1. Gain access to the inboard and outboard ends of the flap drive torque tube.
2. Visually inspect for signs of cracking, i.e. flaked paint etc. in areas indicated ref. Figure 1. If in doubt remove paint locally and use dye penetrant as required.
3. If no cracks are present, annotate logbook "SB172 complied with". Note if paint removed, clean and repaint.
4. If cracking is present, obtain new welded item T67G-45-243/244 from Slingsby Aviation Limited. Annotate logbook "SB 172 complied with, Mod M948 invoked".

For replacement parts, please contact SAL Customer Support Department.

Note: The incorporation of Modification M948 supersedes the requirements of this Service Bulletin SB 172.

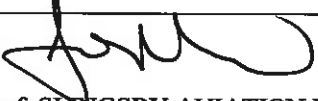
Approved by: 	Date: 23/12/03	Issue 3
For and on behalf of SLINGSBY AVIATION LIMITED	Page 1	of 2
Kirkbymoorside, York. YO62 6EZ Fax No: 01751 431173	Tel: 01751 432474 E-mail: SAL5@Slingsby.co.uk	

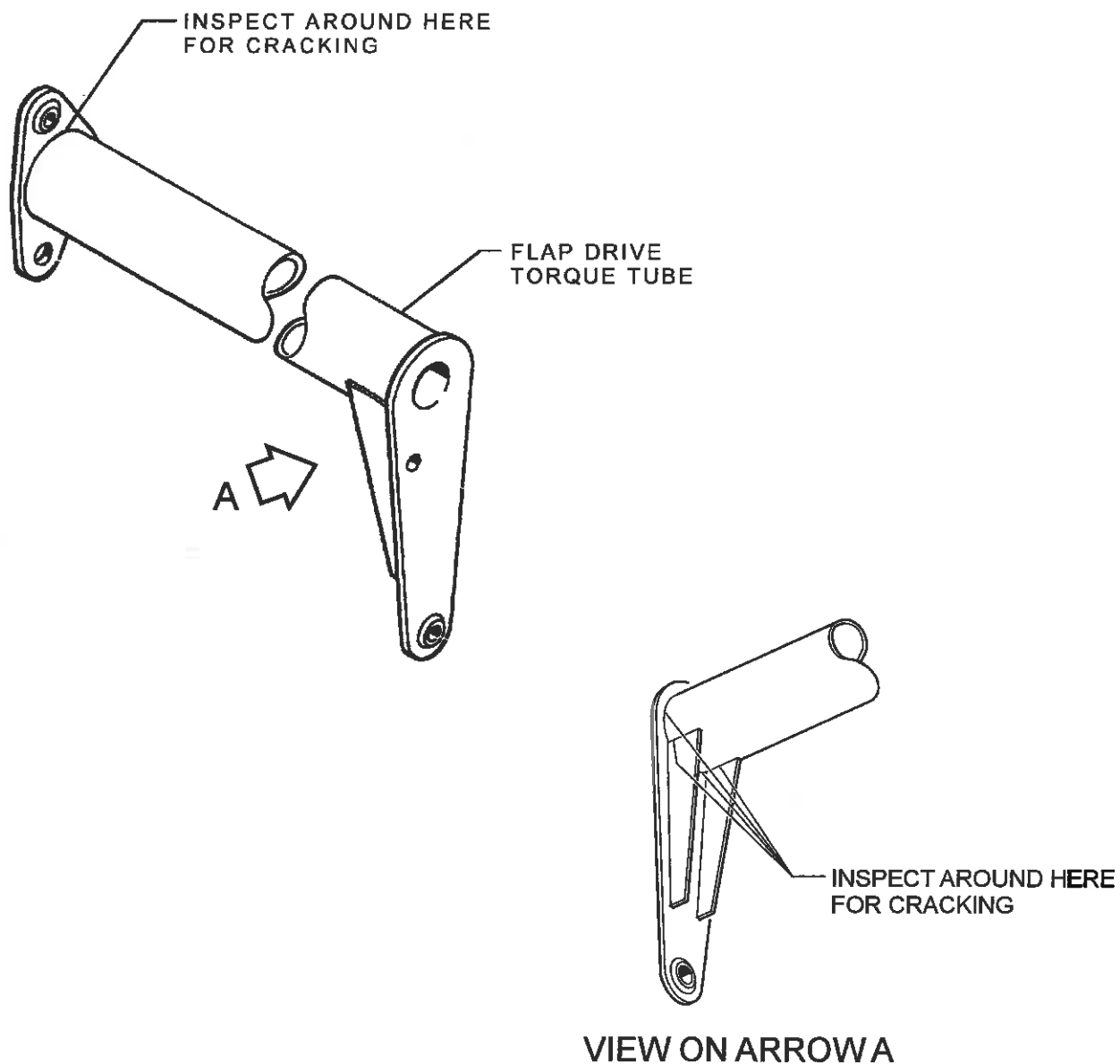

**FIGURE 1**